

INTERSTATE 80

SUN PRAIRIE WEST

SUN PRAIRIE EAST

P.S. TOTAL  
 GROSS ACRES: 45 56  
 DWELLING UNITS: 242 272  
 DENSITY: 5.38 4.45  
 SEWER EQUIVALENT: 542.6 546.0

GROSS ACRES: 25  
 DWELLING UNITS: 294  
 DENSITY: 11.76 DU/A  
 SEWER EQUIVALENT: 611.6 PEOPLE

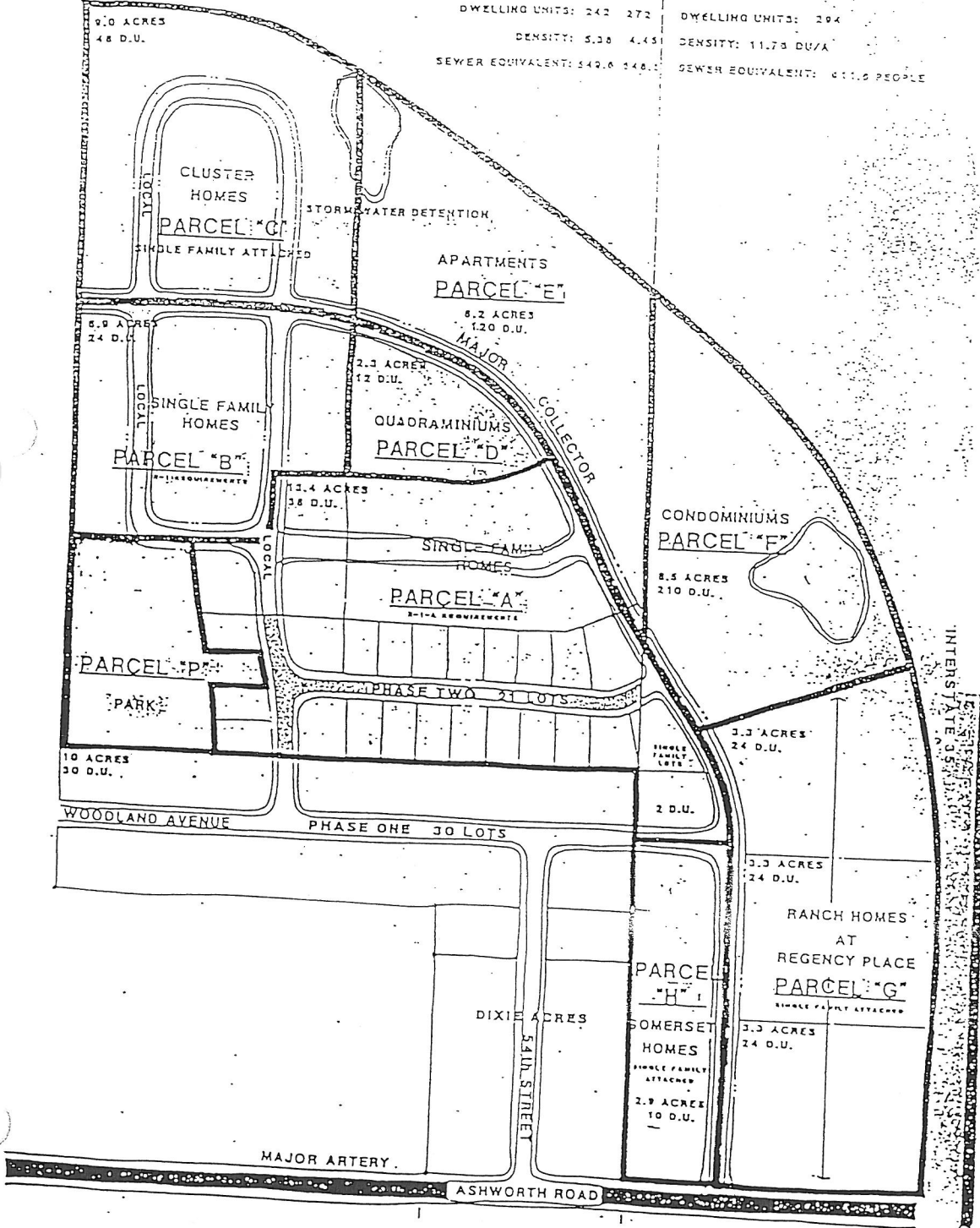

9.0 ACRES  
48 D.U.  
 CLUSTER HOMES  
 PARCEL "C"  
 SINGLE FAMILY ATTACHED

STORMWATER DETENTION  
 APARTMENTS  
 PARCEL "E"  
 6.2 ACRES  
120 D.U.

5.9 ACRES  
24 D.U.  
 SINGLE FAMILY HOMES  
 PARCEL "B"

2.3 ACRES  
12 D.U.  
 QUADRAMINIUMS  
 PARCEL "D"

11.4 ACRES  
38 D.U.  
 SINGLE FAMILY HOMES  
 PARCEL "A"  
 2-1-A REQUIRMENTS

CONDOMINIUMS  
 PARCEL "F"  
 8.5 ACRES  
210 D.U.

PARCEL "P"  
 PARK

PHASE TWO 31 LOTS

3.3 ACRES  
24 D.U.  
 SINGLE FAMILY LOTS  
 2 D.U.

10 ACRES  
30 D.U.  
 PHASE ONE 30 LOTS

3.3 ACRES  
24 D.U.

RANCH HOMES  
 AT  
 REGENCY PLACE  
 PARCEL "G"  
 SINGLE FAMILY ATTACHED

DIXIE ACRES  
 SAIN STREET

3.3 ACRES  
24 D.U.  
 SOMERSET HOMES  
 SINGLE FAMILY ATTACHED  
 2.9 ACRES  
10 D.U.

MAJOR ARTERY  
 ASHWORTH ROAD

INTERSTATE 80

